

# Ex db eb IIC CONTROL STATIONS AND Ex eb IIC TERMINAL BOXES



CONTROL STATIONS

TERMINAL BOXES

CE2K-...-series of terminal boxes is suitable to contain Ex i terminals for incoming/outgoing cable connections. The control and signalling units series CE2K-...-CS-SSX can be equipped with certified components. Terminal boxes and control stations are available in Stainless Steel SS316L or in GRP (Glass Reinforced Polyester) material.

**Combustion and Energy Ex db and Ex eb terminal boxes and control stations are ATEX and INMETRO certified.**



# GRP CONTROL STATIONS TECHNICAL SPECIFICATIONS



## DESCRIPTION

The CE2K-... ..-CS-GRP range includes 25 sizes of enclosures manufactured in GRP (glass reinforced polyester) with 4mm thickness, that can be threaded.

Polyester is a valid alternative to aluminum, stainless steel or cast iron; it has excellent mechanical strength and a long life expectancy.

The boxes series CE2K-... ..-CS-GRP are able to operate in an ambient temperature from -60°C to +85°C and consist of enclosures having degree of protection IP66 (with red or white colour silicone gasket placed on internal part of the lid) or IP66/67 (as option).

The control and signalling units series CE2K-... ..-CS-GRP can be equipped with certified components like:

- ammeter/voltmeter;
- switch module (for push-button, selector switch, control switch, etc.) and relevant actuator;
- safety switch;
- signalling lamp or Led; illuminated button;
- fuse;
- potentiometer.

Temperature class depends on the temperature class of the “hottest” component(s): if at least one component having temperature class T5 or T4 is mounted, the temperature class shall be T5 or T4.

The maximum permissible ambient temperature of the certified operators shall duly be considered.

For area of drilling on the lid must be considered the lid dimensions less 15%.

## MATERIAL

Enclosure material: Black glass fibre reinforced polyester resin graphite added (surface resistance <1GΩ)

## Ex CODE

Ex marking:  II 2 GD  
Ex eb IIC T6/T5 Gb  
Ex tb IIIC T85°C / T100°C Db



# GRP CONTROL STATIONS

## TECHNICAL SPECIFICATIONS

### MECHANICAL FEATURES

Thickness:	4mm
Degree of protection:	IP66 (IP66/67 as option)
Back fixing points Gasket:	silicone
Mounting plate:	as option
Mounting plate dimensions:	see technical details
Cover:	solid
Cover fixing:	by screws

### ELECTRICAL FEATURES

Max. rated voltage (Ex e):	11k VAC or VDC
Max. rated voltage (Ex i):	30 VAC or VDC
Frequency:	50/60 Hz
Maximum rated current:	520A
Maximum rated cross section:	300sqmm

### Ex FEATURES

Standards:	EN 60079-0 / EN 60079-1 / EN 60079-7 / EN 60079-11 / EN 60079-31
Suitable for:	Zone 1 / Zone 2 / Zone 21 / Zone 22

### CERTIFICATES

Certificates Number:	 CEC 15 ATEX 211
	 INMETRO certificate available upon request



#### Web

www.ce2k.com - info@ce2k.com

#### Contacts

Ph: +39 0341.260926

rev\_240712

# GRP CONTROL STATIONS - DIMENSIONS

Model	External dimensions			Internal dimensions			Fixing		Screw
	H	W	D	h	w	d	H+	W+	
	mm	mm	mm	mm	mm	mm			
CE2K-12 12 09-CS-GRP	120	122	90	102	104	80	82	106	M6
CE2K-12 22 09-CS-GRP	120	220	90	102	190	80	82	204	
CE2K-16 16 09-CS-GRP	160	160	90	142	112	80	110	140	
CE2K-16 26 09-CS-GRP	160	260	90	142	212	80	110	240	
CE2K-16 36 09-CS-GRP	160	360	90	142	312	80	110	340	
CE2K-16 56 09-CS-GRP	160	560	90	142	512	80	110	540	
CE2K-20 25 12-CS-GRP	200	250	120	180	230	110			
CE2K-25 25 12-CS-GRP	250	255	120	230	235	110	200	235	
CE2K-25 25 16-CS-GRP	250	255	160	230	235	140			
CE2K-25 40 12-CS-GRP	250	400	120	230	380	110	200	380	
CE2K-25 40 16-CS-GRP	250	400	160	230	380	160			
CE2K-25 60 12-CS-GRP	250	600	120	230	580	110			
CE2K-25 60 16-CS-GRP	250	600	160	230	580	140			
CE2K-40 40 12-CS-GRP	405	400	120	385	580	110			
CE2K-40 40 16-CS-GRP	405	400	165	385	380	154	355	380	

Dimensions and weights are approximate and subject to change without notice.

Table above refers to Control Station with bolted cover. For the dimensions of Control Stations with hinges ask to info@ce2k.com.



# GRP CONTROL STATIONS - DRAWINGS

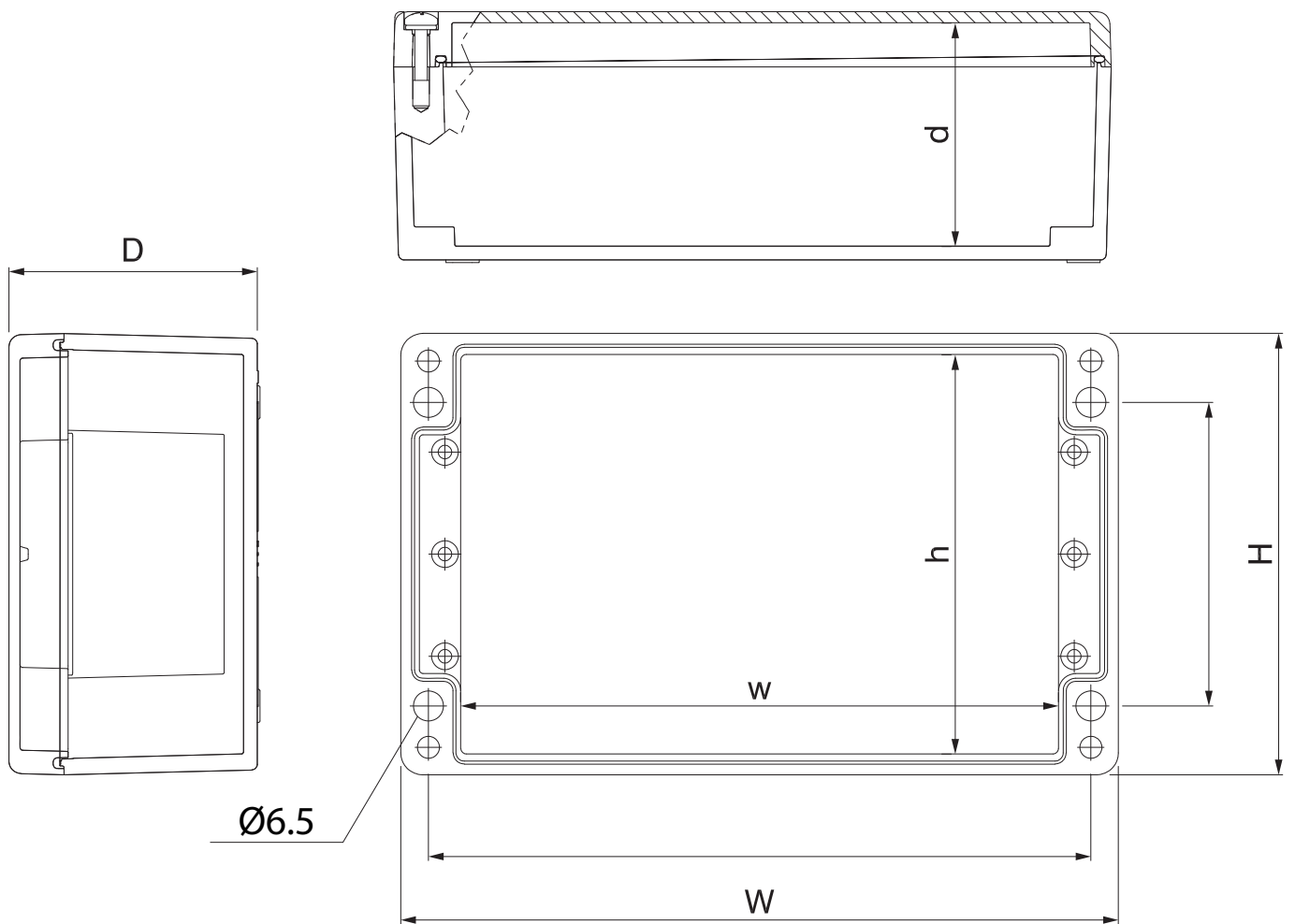

## Web

www.ce2k.com - info@ce2k.com

## Contacts

Ph: +39 0341.260926

rev\_240712